

KEY

- Site Boundary
- 1km Study Area
- UKHO Wrecks and Obstructions - Point
- UKHO Wrecks and Obstructions - Polygon
- Protected Wreck
- Maritime Heritage Assets - Point
 - Post-Medieval
 - Modern
 - Unknown
- Maritime Heritage Assets - Polygon
 - Prehistoric
 - Medieval
 - Post-Medieval
 - World War I
 - World War II
 - Modern

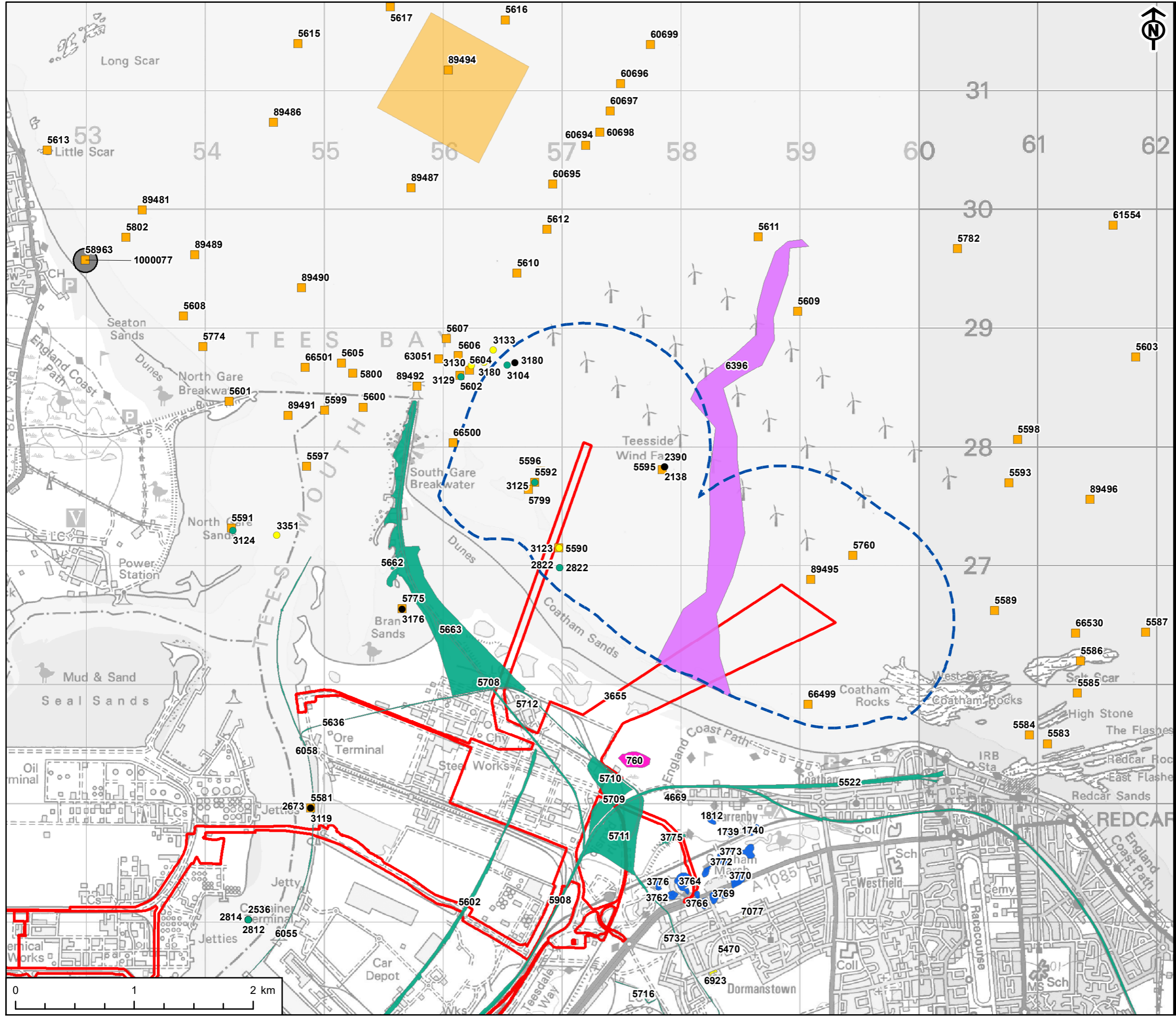

TITLE
FIGURE 19-1
LOCATION OF MARINE HERITAGE
ASSETS IN THE 1KM STUDY AREA

REFERENCE
NZN_220412_ES_19-1_v3

SHEET NUMBER
1 of 1

DATE
12/04/2022

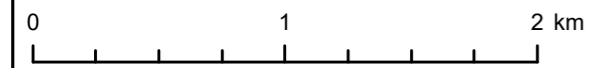

This drawing has been produced for the use of AECOM's client. It may not be used, modified or relied upon by third parties, except as agreed by AECOM or as required by law. AECOM accepts no responsibility, and denies any liability whatsoever, to any party that uses or relies upon this drawing without AECOM's express written consent. All dimensions are indicative and in metres unless otherwise noted. Do not scale this document.